



16, The Green, Quinton, Birmingham, B32 1BF

### Offers In The Region Of £390,000

- MODERN DETACHED BUNGALOW BUILT BY ALLSTAR DEVELOPMENTS LTD
  - THREE BEDROOMS
- FITTED KITCHEN, WELL APPOINTED BATHROOM AND ENSUITE SHOWER ROOM
  - LANDSCAPED REAR GARDEN WITH ARTIFICIAL GRASS AND PATIO
  - DOUBLE GLAZED WINDOWS AND UNDER FLOOR HEATING
  - GARAGE WITH ELECTRIC DOOR AND CAR CHARGE POINT

All Buildings Great & Small



**RICS**  
Regulated by RICS

arla naea  
propertymark



intertek  
ISO 9001:2015



OnTheMarket

rightmove



A modern three bedroom detached bungalow built by Allstar Developments LTD with conservatory, landscaped rear garden and garage

Accommodation comprising enclosed porch, lounge, kitchen, dining room/bedroom three, well appointed bathroom, two further bedrooms (one with en-suite shower room ), conservatory, gas boiler providing underfloor heating, double glazing to windows as detailed, garage, landscaped rear garden, car charging point, alarm.

#### ENCLOSED PORCH (front)

Double glazed composite front door and obscure double glazed windows, LVT floor finish, alarm system, door opening onto

#### LOUNGE (front) 4.05m x 4.61m (2.85m)

LVT floor finish, coving to ceiling, double glazed window to front, glass panel onto dining room/bedroom three,

#### FITTED KITCHEN (front) 2.44m x 3.99m

Double glazed window, recessed spotlights to ceiling, LVT Floor finish, bowl and a half single drainer stainless steel sink with mixer tap, range of base units with soft close cupboards and drawers, complimentary worktops with upstands, wall mounted store cupboards at high level, integrated appliances to include AEG microwave oven/grill, AEG cooker, AEG induction electric hob, AEG cooker hood, integrated fridge freezer, integrated dishwasher and washer/dryer, cupboard housing "Worcester" gas boiler, obscure double glazed door to side,

#### DINING ROOM/BEDROOM THREE (side) 2.85m (1.55m) x 2.57m

Double glazed window to side, LVT floor finish, glass panel to living room, access to roof space,

#### WELL APPOINTED BATHROOM (side) 2.27m x 1.68m

Double glazed key light roof window, heated towel rail, LVT Floor finish, panel bath with shower over bath, recessed spotlight to ceiling, extractor, WC with push button flush, wash hand basin with vanity unit and mixer tap, mirror with light, walls to bath tiled to full height, further walls tiled to approximately half wall height,

#### BEDROOM TWO 2.85m x 3.53m

Double glazed window, LVT floor finish,

#### BEDROOM ONE 3.51m x 3.23m plus 0.99m x 1.93m

Coving to ceiling, LVT Floor finish, fitted wardrobe, double glazed double doors onto conservatory.

#### EN-SUITE SHOWER ROOM 1.65m x 1.11m plus shower cubicle

LVT floor finish, heated towel rail, WC with push button flush, wash hand basin with mixer tap and vanity unit, mirror with light, extractor, wall tiled to approximately half wall height, shower cubicle tiled to full wall height, recessed spotlights to ceiling, double glazed key light roof window.

#### CONSERVATORY 2.90m x 2.78m

Tiled floor finish, double glazed windows and double glazed double doors onto landscaped rear garden.

#### LANDSCAPED REAR GARDEN

Paved patio area, paving stones and artificial grass, raised borders, bench, garden enclosed with brick wall fencing,

#### GARAGE (not measured)

Electric door with remote

#### COUNCIL TAX BAND D

#### WARRANTY

The property was purchased with the benefit of a 10 year warranty from 2019.

#### TENURE

We are verbally advised the property is freehold. The Agent has not checked the legal documents to verify the freehold status of the property. The buyer is advised to obtain verification from their Solicitor or Surveyor.

#### SERVICES

The Agents have not tested any apparatus, equipment, fixtures, fittings or services and so cannot verify they are in working order or fit for their purpose. The buyer is advised to obtain verification from their Solicitor or Surveyor.

#### FIXTURES AND FITTINGS

All items unless specifically referred to in these sales particulars are expressly excluded from the proposed sale. However, fitted carpets, curtains and certain other items may be taken at a valuation to be agreed.

#### Money Laundering Regulations –

In order to comply with Money Laundering Regulations, all prospective purchasers are required to provide the following - 1. Satisfactory photographic identification. 2. Proof of address/residency. 3. Verification of the source of purchase funds including bank statements for deposits in order to purchase and copy of mortgage agreement in principle from the appropriate lender. In the absence of being able to provide appropriate physical copies of the above, Scriven & Co reserves the right to obtain electronic verification of identity.

#### Extra services -

By law, the agent must tell the client if the agent or any connected person intends to earn any commission or any other fees from offering or referring other services to the client or buyer. If the agent or any connected person earns money from any of these services or referrals the agent or the connected person would keep this commission or fee. Part of the payment for these extra services will be paid to the agent as a result of the referral.

Scriven & Co offers the following services and has the following referral arrangements in place:

Scriven & Co routinely refers sellers (and buyers) to Infinity Financial Advice. It is the clients' or buyers' decision whether to choose to deal with Infinity Financial Advice. Should the client or a buyer decide to use Infinity Financial Advice the client or buyer should know that Scriven & Co

receive a payment from Infinity Financial Advice equating on average to a figure in the order of £200 per referral. Scriven & Co routinely refers sellers (and buyers) to certain firms of solicitors/conveyancers. It is the clients' or buyers' decision whether to choose to deal with any of the referral companies. Should the client or a buyer decide to use any of these companies the client or buyer should know that Scriven & Co receive a payment from these companies equating to a figure in the order of £100-£200 per referral. We are informed that the solicitors/conveyancers are happy to pay this referral fee to ourselves as it significantly reduces the marketing costs that they have to allocate to sourcing new business. The referral fee is NOT added to the conveyancing charges that would ordinarily be quoted.

The agent routinely refers sellers (and buyers) to Warren's removals and storage. It is the clients' or buyers' decision whether to choose to deal with Warren's removals and storage. Should the client or a buyer decide to use Warren's removals and storage the client or a buyer should know that the agent receives a referral fee to the value of £50 from them for recommending a client or buyer to them.

Useful links for property information:

Find information about a property in England or Wales:  
<https://search-property-information.service.gov.uk>

Mobile and broadband checker: If mobile coverage and broadband speed is an important issue we would suggest checking with: <https://checker.ofcom.org.uk>

Flooding: If you wish to check flooding information in respect of the property, the following may be of assistance: <https://www.gov.uk/request-flooding-history>

Long term flood risk check of an area in England:  
<https://www.gov.uk/check-long-term-flood-risk>

Service provider information: we would suggest the following:

Gas supply:  
<https://www.ofgem.gov.uk/information-consumers/energy-advice-households/finding-your-energy-supplier-or-network-operator>  
<https://www.findmysupplier.energy>

Electric supply:  
<https://www.energynetworks.org/customers/find-my-network-operator>  
<https://www.nationalgrid.co.uk>

Water supplier:  
<https://www.ofwat.gov.uk/households/your-water-company>  
<https://www.water.org.uk/customers/find-your-supplier>

Consumer code for house builders:  
<https://consumercode.co.uk>

#### Important notices

**The Consumer Protection from Unfair Trading Regulations 2008 and the Business Protection from Misleading Marketing Regulations 2008** : Nothing concerning the type of construction or the condition of the structure is to be implied from the photograph (or artists impression) of the property. Items shown in photographs are NOT included unless specifically mentioned within the sales particulars. Certain items may however be available by separate negotiation. The measurements supplied are for general guidance, and as such must be considered as incorrect. A buyer is advised to re-check the measurements themselves before committing themselves to any expense. The Agent has not tested any apparatus, equipment, fixtures, fittings or services, and so does not verify they are in working order, fit for their purpose, or within ownership of the sellers, therefore the buyer must assume the information given is incorrect. Neither has the Agent checked the legal documentation to verify legal status of the property or validity of any guarantee. A buyer must assume the information is incorrect, until it has been verified by their own solicitors. The sales particulars may change in the course of time, and any interested party is advised to make final inspection of the property prior to exchange of contracts. A buyer must check the availability of any property and make an appointment to view before embarking on any journey to see a property. References to the Tenure of a Property are based on information supplied by the Seller. The Agent has not had sight of the title documents. A Buyer is advised to obtain verification from their Solicitor. Any reference to alterations to, or use of any part of the property, is not a statement that any necessary planning, building regulation or other consent has been obtained. A buyer must assume the information is incorrect until it has been verified by their own solicitors.

**VAT**: All figures quoted are exclusive of VAT where applicable. **Rating Assessments** : Where provided the Agent has made a verbal enquiry with the Local Authority and this information should be verified by interested parties making their own enquiries.

**Misrepresentation Act 1967** : These details are prepared as a general guide only, and should not be relied upon as a basis to enter into a legal contract, or to commit expenditure. An interested party should consult their own surveyor, solicitor or other professionals before committing themselves to any expenditure or other legal commitments. If any interested party wishes to rely upon any information from the Agent, then a request should be made and specific written confirmation can be provided. The Agent will not be responsible for any verbal statement made by any member of staff, as only a specific written confirmation should be relied upon. The Agent will not be responsible for any loss other than when specific written confirmation has been requested. (REV02:10/13).



















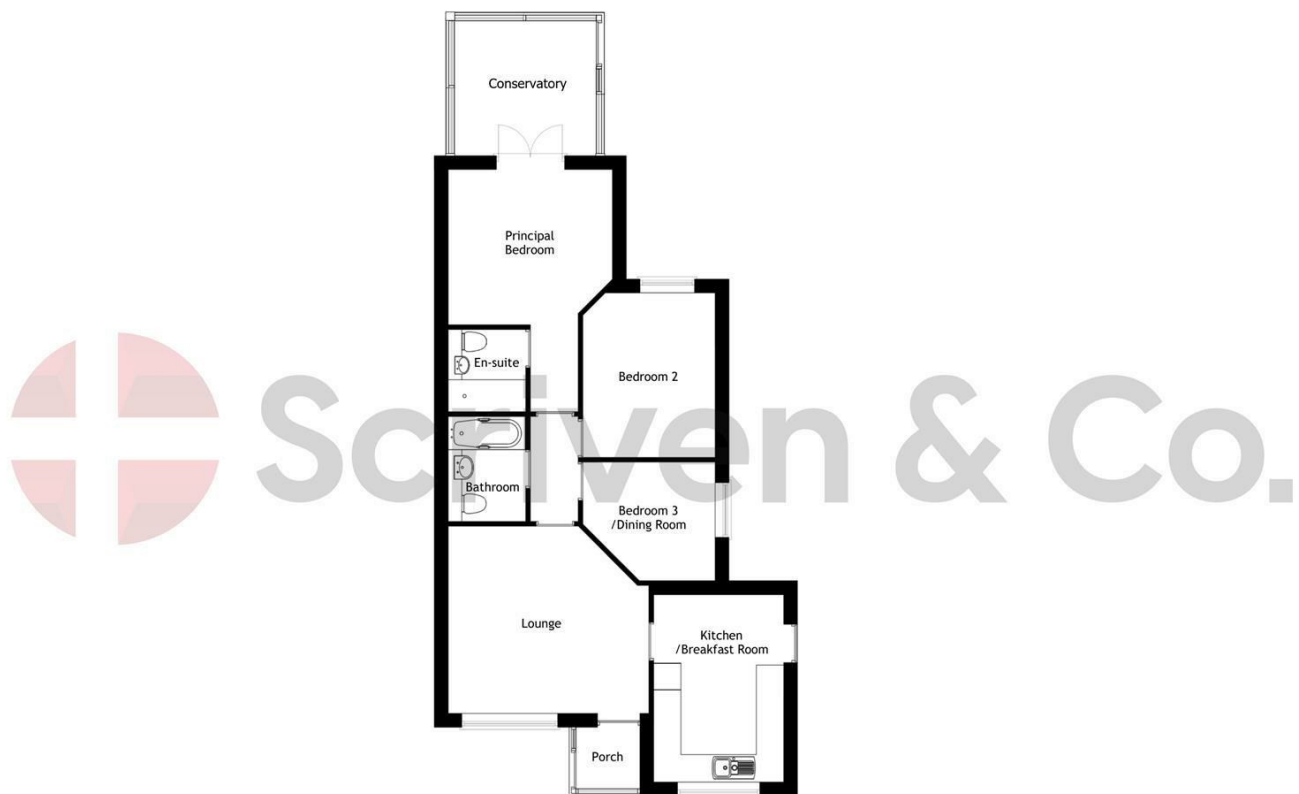

Not to scale. This floor plan is for illustration purposes only.  
The position and size of doors, windows and other features are approximate.



■ Estate House, 821 Hagley Road West,  
Quinton, Birmingham, B32 1AD

■ Tel: 0121 422 4011

■ E-mail: [quinton@scriven.co.uk](mailto:quinton@scriven.co.uk)

■ [www.scriven.co.uk](http://www.scriven.co.uk)

■ Regulated By RICS

Energy Efficiency Rating		
	Current	Potential
Very energy efficient - lower running costs		
(92 plus) <b>A</b>		<b>95</b>
(81-91) <b>B</b>	<b>82</b>	
(69-80) <b>C</b>		
(55-68) <b>D</b>		
(39-54) <b>E</b>		
(21-38) <b>F</b>		
(1-20) <b>G</b>		
Not energy efficient - higher running costs		
<b>England &amp; Wales</b>	EU Directive 2002/91/EC 	

Property Reference: 18340485